



## NORTEC L 36 x M + RL

### Raised floor

The raised access floor system NORTEC is the ideal product for nearly all applications with its excellent technical and building-physical characteristics. The raised access floor panels consist of fibre-reinforced calcium sulphate. The panels are protected against shock and humidity by an edge trim on all edges. The substructure consists of height-adjustable zinc-coated steel pedestals from our own production which form the necessary cavity for installations and gaskets for sound decoupling. Stringers are hinged in between the pedestals for horizontal reinforcement and increase of loadability.

- superb walking comfort
- very high loadability
- non-combustible
- simple lifting and exchanging of single panels
- very wide choice of coverings
- complete substructure is tested to be free of zinc whiskers

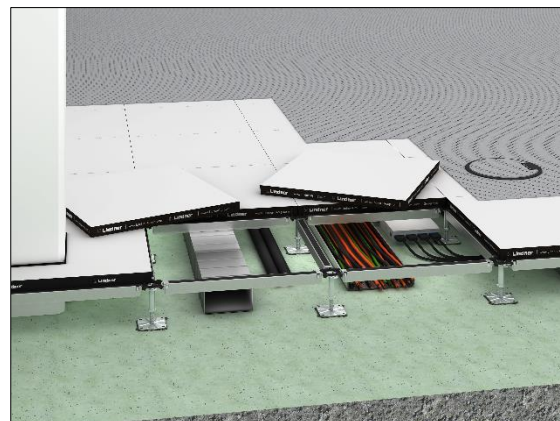

### Technical data

Weight	61 kg/m <sup>2</sup>
Panel thickness	36 mm
Standard pedestal height	25 - 2,000 mm
Pedestal grid	600 mm x 600 mm
Dimensional deviation	class 1
Earth resistance	$\geq 1 \times 10^6 \Omega$

### Statics

Load and deflection class	EN 12825	2A
Point load (breaking load)	EN 12825	3 kN (6 kN)
Seismic safety		earthquake-proof construction possible



## Fire protection

### Building material class of the carrier panel

Building material class	EN 13501-1	A1
Designation by the building authorities	EN 13501-1	non-combustible

### Fire resistance

Fire resistance	DIN 4102-2	F 30 F 60
-----------------	------------	--------------

## Acoustics

### Building acoustics

Normalised flanking level difference without covering	DIN EN ISO 10848	$D_{n,f,w}$	54 dB
Normalised flanking level difference with covering ( $\Delta L_w = 26$ dB)	DIN EN ISO 10848	$D_{n,f,w}$	56 dB
Rated sound reduction index without covering	DIN EN ISO 10140-2	$R_w$	61 dB
Reduction of impact sound pressure level without covering	DIN EN ISO 10140-1	$\Delta L_w$	17 dB
Reduction of impact sound pressure level with covering ( $\Delta L_w = 25$ dB)	DIN EN ISO 10140-1	$\Delta L_w$	27 dB
Reduction of impact sound pressure level with covering ( $\Delta L_w = 25$ dB), with damping pad type PU	DIN EN ISO 10140-1	$\Delta L_w$	38 dB
Normalised flanking impact sound pressure level without covering	DIN EN ISO 10848-2	$L_{n,f,w}$	70 dB
Normalised flanking impact sound pressure level with covering ( $\Delta L_w = 26$ dB)	DIN EN ISO 10848-2	$L_{n,f,w}$	38 dB

## Sustainability

Circular economy	Cradle to Cradle Certified® Silver
Self-declaration	self-declaration in acc. with ISO 14021
Environmental product declaration	verified EPD in acc. with EN 15804 / ISO 14025
FSC	optional (TUEV-COC-000515)
French VOC Regulation	Emission class A+

## Floor coverings

Suitability of covering	elastic coverings, textile coverings, loose-laid tiles, STONELINE
-------------------------	---